



CHATTERTON | REES



Weatherby Talbot Road

Notting Hill, London, W2 5LF

£750,000



Weatherby Talbot Road



Description

A brilliant two/ three bedroom split level apartment on Talbot Road in Notting Hill. Spread over the first and second floor of a purpose built block there are two double bedrooms and one bathroom a large semi open kitchen to the living and dining room that has the benefit of direct access on to a south facing terrace. There is a study room that has in the past been used as a guest bedroom.

The property is in good condition and has 823sqft of internal space, a recently extended lease with a beautiful view of Talbot Road and only moments from Portobello Road and plenty of restaurants and shops almost on your doorstep.

- Two / three bedrooms
- Terrace
- 823sqft
- Split Level
- Recently Extended Lease
- Amazing Location





Floor Plan

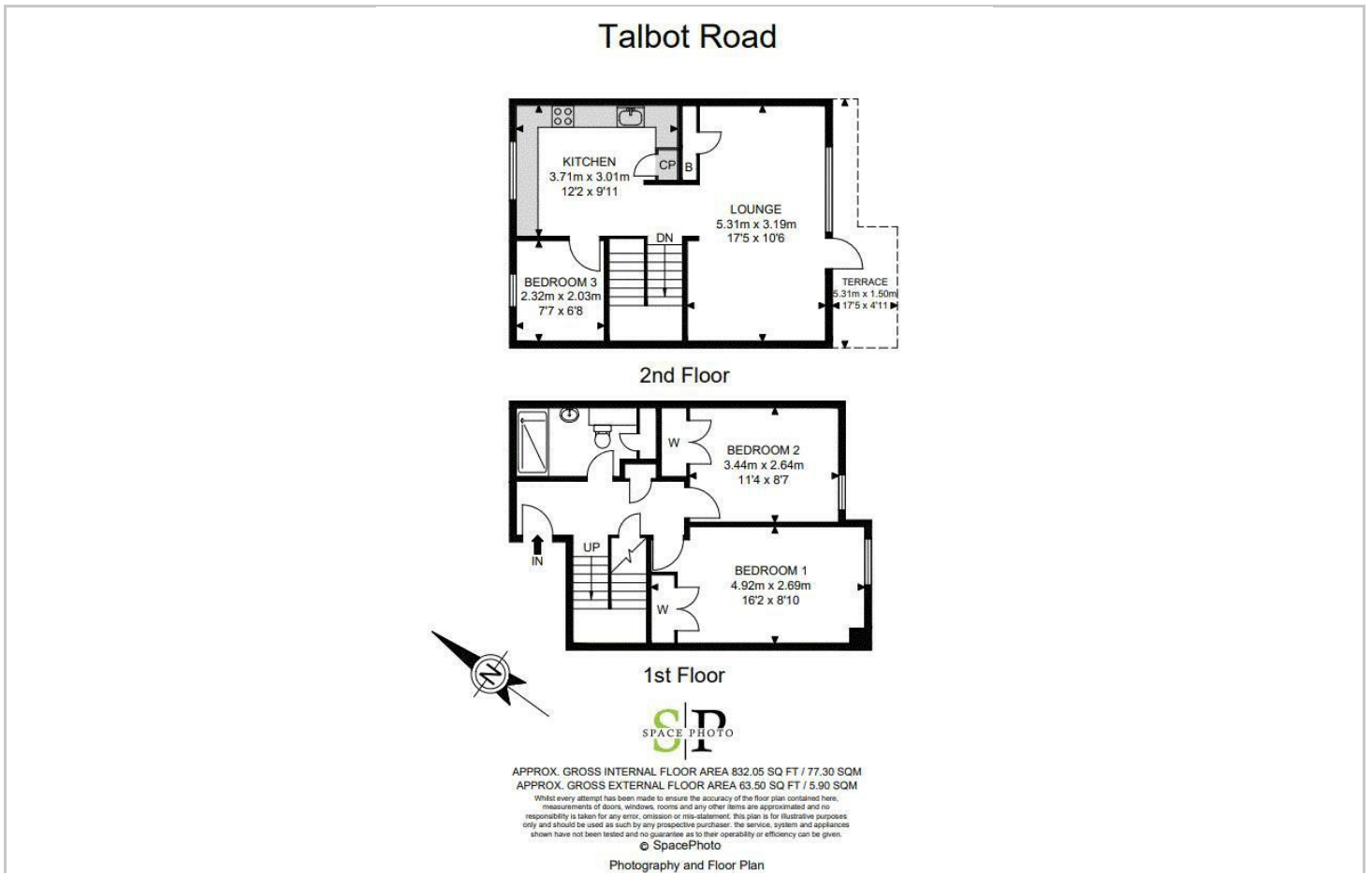

Area Map

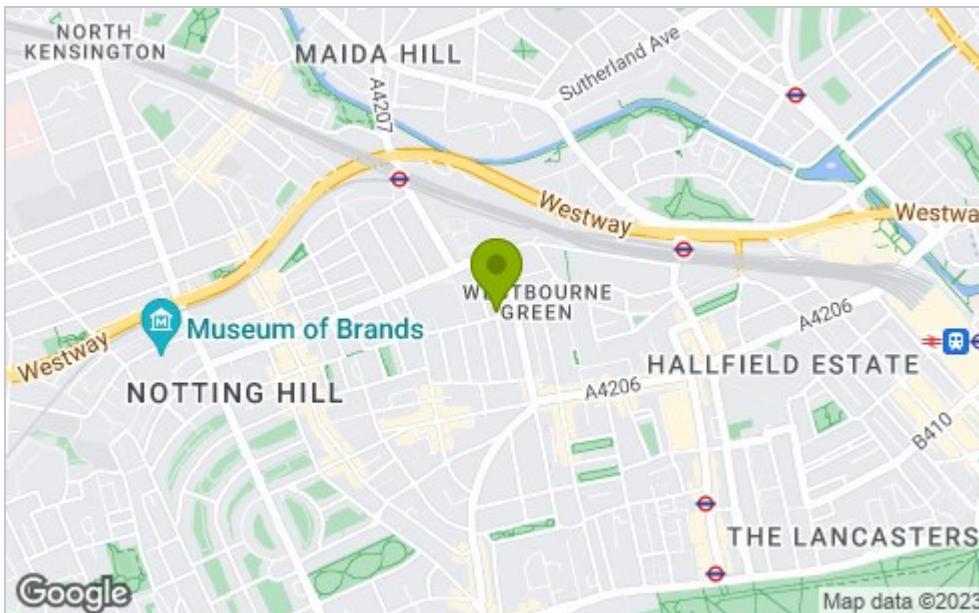

Viewing

Please contact our Chatterton Rees Office on 020 3780 0580 if you wish to arrange a viewing appointment for this property or require further information.

These particulars, whilst believed to be accurate are set out as a general outline only for guidance and do not constitute any part of an offer or contract. Intending purchasers should not rely on them as statements of representation of fact, but must satisfy themselves by inspection or otherwise as to their accuracy. No person in this firm's employment has the authority to make or give any representation or warranty in respect of the property.

Energy Efficiency Graph

Energy Efficiency Rating		Current	Potential
Very energy efficient - lower running costs			
(92 plus) A			
(81-91) B			
(69-80) C			
(55-68) D			
(39-54) E			
(21-38) F			
(1-20) G			
Not energy efficient - higher running costs			
England & Wales		EU Directive 2002/91/EC	
Environmental Impact (CO ₂) Rating		Current	Potential
Very environmentally friendly - lower CO ₂ emissions			
(92 plus) A			
(81-91) B			
(69-80) C			
(55-68) D			
(39-54) E			
(21-38) F			
(1-20) G			
Not environmentally friendly - higher CO ₂ emissions			
England & Wales		EU Directive 2002/91/EC	